

NORTHFIELD PUBLIC SCHOOLS
Office of the Superintendent
Memorandum

TO: Board of Education
FROM: Matt Hillmann Ed.D., Superintendent
RE: Table File Items for June 11, 2018, Regular School Board Meeting

VI. Consent Agenda

B. Co-Curricular Overnight Trips for 2018-2019

Middle School teacher Earl Weinmann is requesting School Board approval for a co-curricular overnight trip for the 2018-2019 school year.

VIII. Items for Information

A. End of the Year Enrollment Report

SUBMITTED BY: EARL WEINMANN - NORTHFIELD MIDDLE SCHOOL

Policy IICA-E

OVERNIGHT STUDENT FIELD TRIPS

Proposal

Overnight student field trips must receive prior approval by the Board of Education. Proposals for overnight student field trips should be submitted first to the Building Principal and include the following:

Date of Proposal: Saturday, June 8 - Sunday, June 9, 2019

Purpose of Trip: To visit sites connected with the James and Younger Gang

Attach Dates and Itinerary of Proposed Trip.

Describe the educational benefits of the proposed trip. To further educate student tour guides on the life of the James and Younger Gang

List staff involved in planning and organizing the trip. Earl Weinmann

Outline the time commitment anticipated and state the arrangements made to assure that these activities are manageable and will not unduly distract staff from their primary duties. No staff will be affected

What arrangements will be made for transportation? Schmitt & Sons Bus - Lakeville

What arrangements will be made for lodging? Stoney Creek Inn - St. Joseph

Attach a summary of the budget for the proposed trip, including funding source(s), and proposed fundraising activities. School pays transportation costs. All other costs shared by the students and the Northfield Historical Society

Describe the availability of scholarships. None

Number of anticipated student participants. 16 - 20

Number of school staff chaperones. 2-3 (depending on the number of participants)

Number of parent chaperones. 0

Attach a description of activities scheduled for nonparticipating students.
None - summer trip

ST. JOSEPH - KEARNEY, MISSOURI HISTORICAL SOCIETY TRIP

Itinerary

Saturday, June 8

BUS ARRIVES AT APPROXIMATELY 7:15 A.M.

LEAVE NORTHFIELD APPROXIMATELY - 7:30 A.M.

1ST STOP - 8:50 Snack/Bathroom Break. 10 minutes.

Clear Lake: Exit 194

Park at "Kum & Go"

2ND STOP - 10:55 - 11:35 Gas and Lunch

Exit 92, Ankeny, IA

Drop kids off at Arby's. Many places to go. Gas up at Amoco and you won't need to gas up again until St. Joseph. NOTE: to get diesel gas, go West for 4 stop lights to the Hy Vee Gas Station.

3RD STOP - 1:20 - 1:45 Dairy Queen Exit 92, Bethany, Missouri

Ice Cream / Bathroom Break.

4TH STOP - 2:45 - 4:45

Kearney Family Farm. Exit 26 (Hwy 92)

5TH STOP - St. Joseph approximately 5:45 Check in hotel.

St. Joseph Holiday Inn 102 South 3rd Street Downtown Hwy 295 to 229
(exit 43) to 3rd Street (exit 6A)

6TH STOP - 6:00 - 7:30 Supper. Park at *Village Steak House*. Kids can eat where they want

Back to Hotel and Gas up for tomorrow

* On the way back to hotel...drive by antebellum houses on Hall Street. You must take 6th street to get there. 9th St. doesn't run into Hall.

Sunday, June 9

Students will eat breakfast at the Holiday Inn Buffet from 6:00 a.m. - 10:00 a.m

1ST STOP: 9:00 a.m. Patee House Museum / Jesse James House
(right next to Patee House). Kids, if interested, may also go to the
Penn Street Square Antiques after Patee House or students can stay in
Patee House (Penn Street Square is across the street from Patee House)

Meet back on bus at 11:30. On the way out of town...drive by hill which once held Jesse's
house: Go to 13th Street (left from Japanese Tea Garden near Patee House) and take a right on
Lafayette. It is on the right side with a marker.

Take Interstate 36 East to 35 North
Take Highway 35 North into Iowa to highway 2 (exit 12) to Corydon.
Distance from St. Joe to Corydon approximately 134 miles.

TENTATIVE PLAN - DISCUSS WITH DRIVER WHEN LEAVING ST. JOSEPH

Go north on #35 to Winston, Missouri (exit 61) Hwy 69

Go east 3 miles (from I-35 exit) past to just outside Winston and down the hill to the
stone bridge on north side of the highway. Go past the bridge about 1/2 mile to cross road. Turn
around and go back to bridge. Pull off to side (bus is visible enough for traffic to see it from
either direction) Explore under railroad trestle for about 15 - 20 minutes.

2ND STOP: If the students didn't eat breakfast - eat in Corydon at 2:00 at either C.J.'s
Cafe or the Pizzeria both of which are next to each other downtown. If
the students did eat breakfast go to Corydon Museum first and eat afterwards

3RD STOP: Either 2:00 or 3:00 p.m. Prairie Trails Museum of Wayne County (Corydon
Iowa) Highway 2 East (Exit 12 Highway 2)

Leave Corydon by 4:00

4TH STOP: 7:00 - 7:15 Bathroom break Rest area Exit 121

5TH STOP 7:40 - 8:10 Exit 194 near Clear Lake for a late supper.

6TH STOP: Exit 214 (Lake Mills / Northwood exit) Last stop for bathroom at wayside rest in
Northern Iowa.

HOME: Approximately 9:45 Northfield

							2017-2018						
School and	September	September	September	September	October	November	December	January	February	March	April	May	End of Year
Grade Level	5th	8th	15th	22nd	2nd	1st	1st	2nd	1st	1st	3rd	1st	6/8/18
Longfellow													
Early Childhood	71	68	73	75	76	88	99	101	106	110	115	119	115
Total	71	68	73	75	76	88	99	101	106	110	115	119	115
Greenvale Park													
Grade K-2030	87	86	85	85	85	86	85	86	87	86	86	87	85
Grade 1-2029	68	68	68	68	68	69	69	69	67	68	67	68	67
Grade 2-2028	81	81	80	80	80	82	82	79	80	80	80	80	80
Grade 3-2027	77	76	76	76	76	76	75	74	75	77	76	76	76
Grade 4-2026	79	79	79	79	79	79	79	77	78	82	77	77	77
Grade 5-2025	93	94	94	93	93	94	93	92	93	93	93	93	93
Total	485	484	482	481	481	486	483	477	480	486	479	481	478
Sibley													
Grade K-2030	98	95	95	95	95	96	96	96	94	93	92	93	93
Grade 1-2029	86	85	85	85	85	83	83	83	83	83	83	83	83
Grade 2-2028	102	102	102	102	102	102	102	102	101	102	102	102	102
Grade 3-2027	91	92	92	92	92	92	93	91	91	91	90	89	90
Grade 4-2026	108	107	106	106	106	106	106	106	106	106	106	105	105
Grade 5-2025	107	108	108	108	110	109	109	108	109	109	110	110	110
Total	592	589	588	588	590	588	589	586	584	584	583	582	583
Bridgewater													
Grade K-2030	87	87	88	88	88	88	88	92	93	95	96	98	98
Grade 1-2029	97	97	97	97	97	98	99	98	98	97	97	99	98
Grade 2-2028	91	91	92	93	94	94	95	94	95	95	95	96	95
Grade 3-2027	113	113	113	113	113	113	111	113	112	112	113	115	115
Grade 4-2026	90	90	90	90	90	90	92	92	94	93	94	93	94
Grade 5-2025	113	113	113	113	113	113	113	112	112	112	113	113	113
Total	591	591	593	594	595	596	598	601	604	604	608	614	613
Middle School													
Grade 6-2024	329	329	328	327	327	326	325	325	326	327	327	328	328
Grade 7-2023	307	304	304	303	302	302	302	302	301	298	300	302	301
Grade 8-2022	333	330	331	330	329	329	328	329	330	330	333	331	330
St. Dominics	6	6.5	6	6	6	6	6	6	6	6	6	6	6
Total	975	969.5	969	966	964	963	961	962	963	961	966	967	965
High School													
Grade 9-2021	361	359	358	358	356	357	355	357	356	358	357	357	354
Grade 10-2020	325	324	324	325	324	323	321	321	322	322	320	321	320
Grade 11-2019	355	354	353	352	353	355	353	350	345	345	346	345	344
Grade 12-2018	300	299	295	294	294	292	291	288	279	278	277	274	275
Total	1341	1336	1330	1329	1327	1327	1320	1316	1302	1303	1300	1297	1293
ALC													
Grade 9-2021	1	1	2	3	3	3	3	3	4	5	5	4	4
Grade 10-2020	3	3	3	5	5	6	9	9	12	16	16	17	19
Grade 11-2019	15	15	16	19	19	27	29	29	34	39	40	42	40
Grade 12-2018	38	43	48	51	52	59	59	61	59	67	63	57	61
Total	57	62	69	78	79	95	100	102	109	127	124	120	124
Grand Total	4112	4099.5	4104	4111	4112	4143	4150	4145	4148	4175	4175	4180	4171
Full Time only (excluding EC and Part-time/Independent Study ALC)	4028	4022	4017	4013	4012	4010	4002	3999	3999	3995	3986	3991	3984

LongfellowEarly Childhood

Banks	9
Dorey	17
Goldade	16
Kremin	11
Kruse	1
O'Connor	3
Roth	9
Schnorr	7
Sorenson	11
Waters	10
Webster	2
Winter	19
TOTAL	115

**

Greenvale Park

K	Flicek	23	
K	Hagberg	25	
K	Malecha	23	
K	Ziemann	14	
1	Landry	25	C
1	Nivala/Ennis	20	
1	Zach	22	
2	Amundson	26	C
2	Bulfer	18	
	Johnson-		
2	McLaughlin	19	
2	Larson	17	
3	Alvarez, C	21	C
3	Conway	19	
3	Timerson	18	
3	Youngblut	18	
4	Clarey	19	
4	Dimick	16	
4	Garcia	24	C
4	Hetzel	18	
5	Alvarez, R	26	C
5	Harding	22	
5	Sickler	23	
5	Spitzack	22	
	TOTAL	478	

Middle School

Grade 6 -2024	328
Grade 7 (*inc. 3.5 - 1/2 day)-2023	304.5
Grade 8 (*inc. 2.5 - 1/2 day)-2022	332.5
TOTAL	965.0

*12 (6) St. Dominic's students attend ½ day

Early Childhood**	115
Kindergarten-2030	276
Grade 1-2029	248
Grade 2-2028	277
Grade 3-2027	281
Grade 4-2026	276
Grade 5-2025	316
Total K-5	1789
Total Middle School	965
Total High School	1293
GRAND TOTAL	4047.0
ALC 9-12	124
GRAND TOTAL with ALC	4171.0

Full Time only

(excluding EC and Part-time/Independent Study ALC)

3984.0

Sibley

Grade	Teacher		
K	Born	24	
K	Downs	23	
K	Heil	23	
K	Matson	23	
1	Craft	19	
1	Sasse	24	C
1	Sieger	20	
1	Swenson	20	
2	Baker	26	C
2	Seeberg	26	
2	Soderlund	25	
2	Spitzack	25	
3	Guggisberg	23	
3	Jandro	24	
3	Johnson	20	C
3	Sweeney	23	
4	Day	17	
4	Fox	22	
4	Haar	23	
4	McManus	21	C
4	Rud	22	
5	Baragary	29	
5	Malecha	29	
5	Ostermann	23	C
5	Stulken	29	
	TOTAL	583	

Bridgewater

K	Allison	24	
K	Cade	24	
K	Danielson	25	
K	Tran	25	
1	Charlton	25	
1	Ellerbush	24	
1	Hall	24	
1	Lanza	25	C
2	Lane	23	
2	Lofquist	23	
2	Rubin	27	C
2	Schwaab	22	
3	Larson	25	C
	Peterson		
3	(Temple)	22	
3	Ryan	23	
3	Sickler	23	
3	Truman	22	
4	Holden	23	
4	Schuster	23	
4	Shepherd	25	
4	Swenson	23	C
5	DeVries	26	C
5	Duchene	30	
5	Kohl	27	
5	Rauk	30	
	TOTAL	613	

High School

Grade 9-2021	354
Grade 10-2020	320
Grade 11-2019	344
Grade 12-2018	275
TOTAL	1293

ALC

	F/T	**P/T	**I/S	TOTAL
Grade 9-2021	2	0		
Grade 10-2020	9	0	2	4
Grade 11-2019	20	0	10	19
Grade 12-2018	22	0	20	40
TOTAL	53	0	39	61

71

124

Enrollments represent 100% enrolled except where indicated by **

Half day St. Dominic's students are represented by *

2018 MAINTENANCE PROJECTS



**DISTRICT OFFICE SIDEWALK AND
WATER RUN-OFF REPAIRS.**



**RAINWATER RUNOFF GARDEN WILL
HELP WITH FLOODING ISSUES.**



**KITCHEN DISH ROOM FLOOR
SURFACING TO AVOID SLIPS AND
FALLS.**



**3 MORE ROOMS AT SIBLEY WILL HAVE
NEW CABINETS AND COUNTER TOPS.**



HS TENNIS COURT RESURFACING.



**WHEELCHAIR LIFT FOR HS WEIGHT
TRAINING ROOM.**

A photograph of the entrance to Northfield High School. The building is constructed of brick. Above the entrance, there is a large white sign that reads "NORTHFIELD HIGH SCHOOL". Below this, a smaller white sign reads "ACTIVITIES ENTRANCE". The entrance itself consists of several glass doors. To the right of the entrance, there is a large tree with green and yellowing leaves, casting shadows on the brick wall. A paved area leads to the entrance, and a small fenced-in area is visible to the right.

NORTHFIELD HIGH SCHOOL

ACTIVITIES ENTRANCE

SIGNAGE TO CLARIFY HS ENTRANCES.

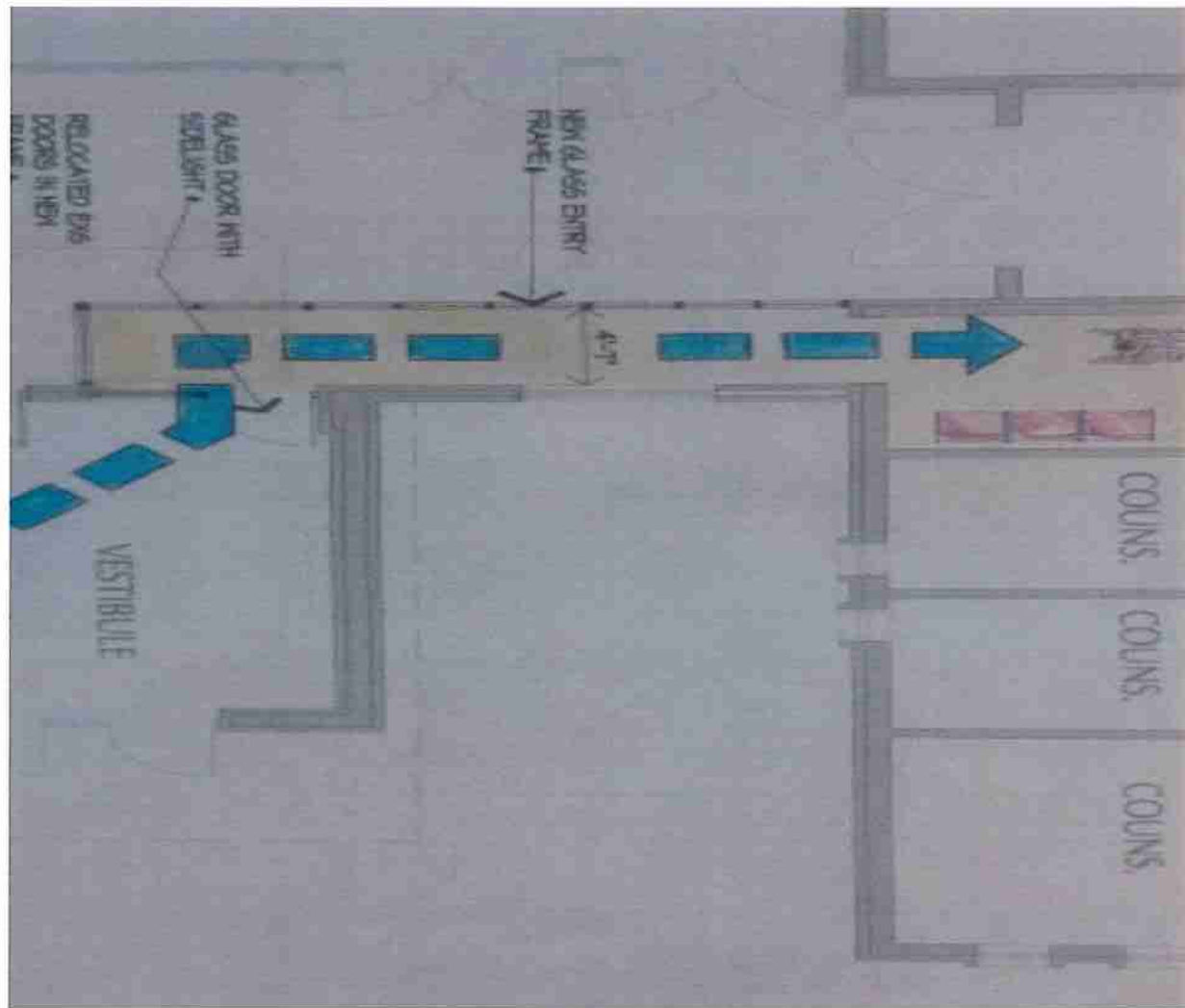

HS SECURED ENTRY CONCEPT.

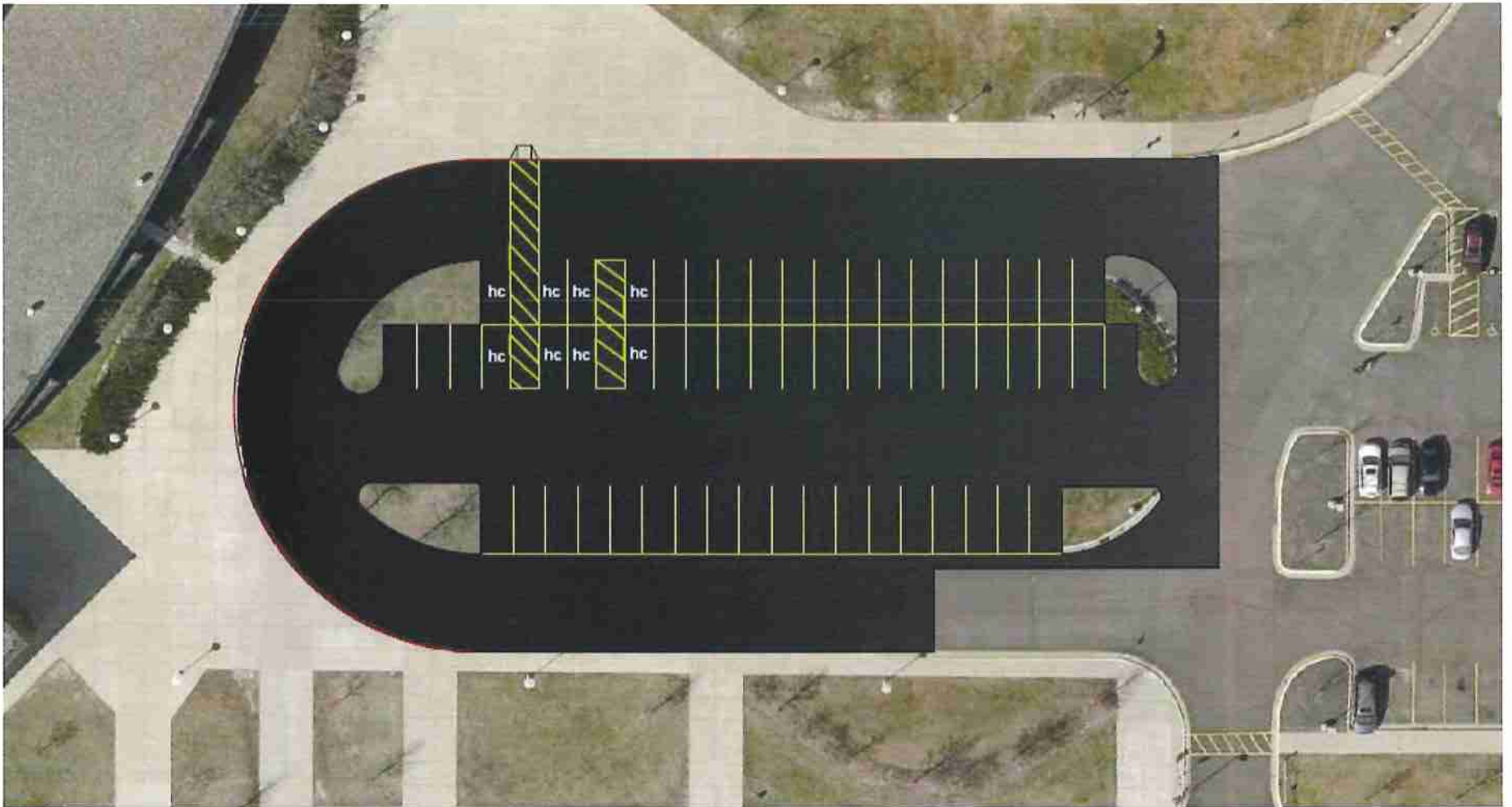

**MS DROP OFF LOOP / HANDICAPPED
ACCESS PARKING AREA.**



MAMAVA LACTATION SUITES FOR EACH BUILDING.

OTHER PROJECTS INCLUDE:

Areas of flooring at GVP and LF.

Sidewalk repair / replacement at GVP.

Air intake grill repairs at the MS.

Placing of UV light for MS pool water sanitization.

Water pressure pumps at the MS for stabilization.

HS and MS door handle hardware replacement.

Concrete flooring and sidewalk repairs at the HS.

Metal cladding of upper mezzanine areas at SB.

Replacement of HS science room sinks and fixtures.

THANK YOU

